



# Gateway

SIEVE & CHAFFER SYSTEM

## *Parts Book*

Two Panel, Single Adjustment Frames

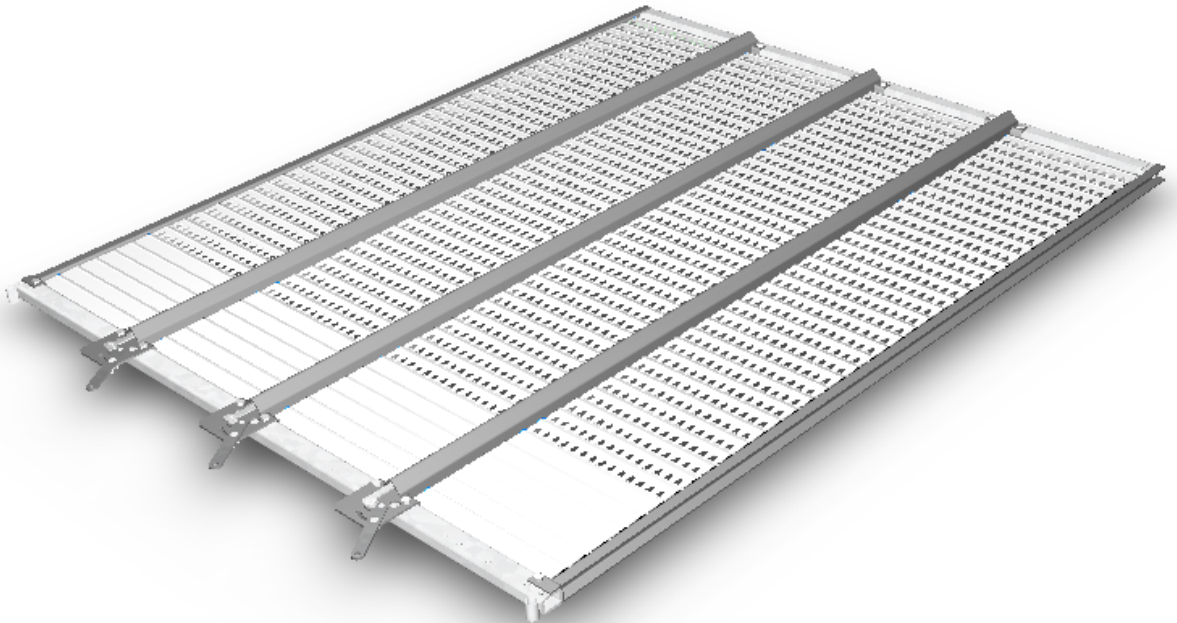

# **GATEWAY DIAGRAM**

The Gateway diagram on this page is generic, covering a wide variety of OEM equipment. A detailed parts list is available on the following page(s) for each specific sieve.

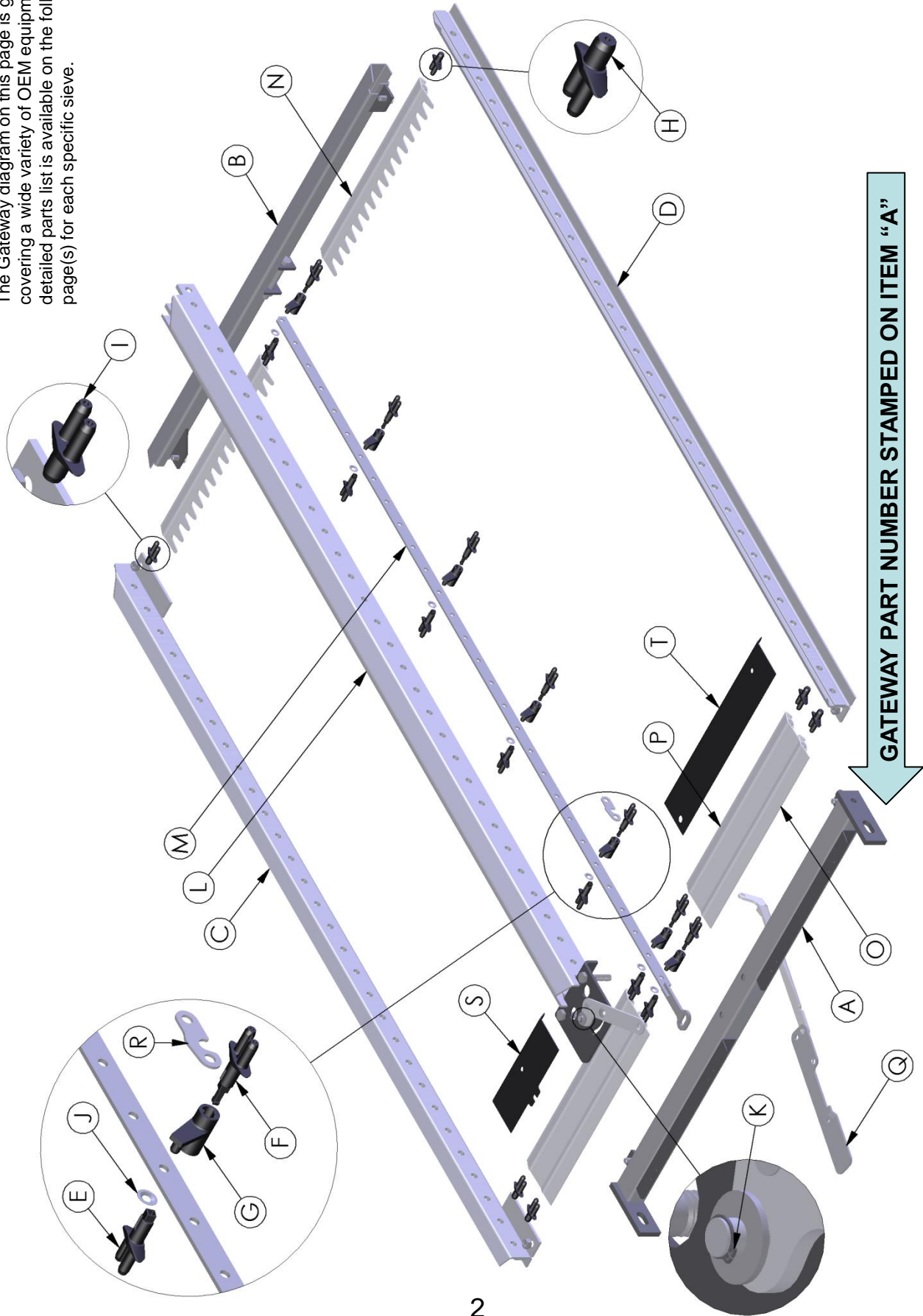



# SERVICE PART LIST

**PART NUMBER: 002620**

REVISION I.D. : **A**

DESCRIPTION: CNH CR970, CR980, 8010 CHAFFER

ITEM	QTY.	PART NUMBER	DESCRIPTION
A	1	709118	REAR TUBE ASSY
B	1	709119	FRONT CHANNEL ASSY
C	1	709120	SIDE CHANNEL ASSY LH
D	1	709121	SIDE CHANNEL ASSY RH
E	40	409000	AXLE CONNECTOR - FEMALE
F	40	409001	AXLE CONNECTOR - MALE
G	40	409002	CRANK ARM - LONG
H	40	409004	END CRANK - R.H.
I	40	409005	END CRANK - L.H.
J	7	212366	PUSHNUT - .250 STUD DIA.
K	1	222040	SNAP RING
L	1	709117	DIVIDER ASSEMBLY
M	1	709122	ADJUST. BAR ASSY
N	78	409175	SLAT
O	2	409220	FLAT SLAT ST
P	-	-	-
-	2	202310	BOLT - MACHINE HEX HD.
-	1	202570	HBOLT 0.3750-16x2.75x1-N
-	4	206070	CAP SCREW - FLAT HD. HX. SOC
-	3	212189	NUT - HEX. LOCK
-	4	212411	LOCKNUT M8-1.25
-	1	214280	WASHER - ST'D. FLAT

**PART NUMBER: 002622**

REVISION I.D. : **A**

DESCRIPTION: CNH CR970, CR980, 8010 CHAFFER

ITEM	QTY.	PART NUMBER	DESCRIPTION
A	1	709118	REAR TUBE ASSY
B	1	709119	FRONT CHANNEL ASSY
C	1	709125	SIDE CHANNEL ASSY LH
D	1	709126	SIDE CHANNEL ASSY RH
E	30	409000	AXLE CONNECTOR - FEMALE
F	30	409001	AXLE CONNECTOR - MALE
G	30	409002	CRANK ARM - LONG
H	30	409004	END CRANK - R.H.
I	30	409005	END CRANK - L.H.
J	7	212366	PUSHNUT - .250 STUD DIA.
K	1	222040	SNAP RING
L	1	709124	DIVIDER ASSEMBLY
M	1	709127	ADJUST. BAR ASSY
N	56	409176	SLAT - GATEWAY LT
O	2	409220	FLAT SLAT ST
P	2	409223	FLAT SLAT LT
-	2	202310	BOLT - MACHINE HEX HD.
-	1	202570	HBOLT 0.3750-16x2.75x1-N
-	4	206070	CAP SCREW - FLAT HD. HX. SOC
-	3	212189	NUT - HEX. LOCK
-	4	212411	LOCKNUT M8-1.25
-	1	214280	WASHER - STD. FLAT

**PART NUMBER: 002621**

REVISION I.D. : **A**

DESCRIPTION: CNH CR970, CR980, 8010 SIEVE

ITEM	QTY.	PART NUMBER	DESCRIPTION
A	1	709123	REAR TUBE ASSY
B	1	709119	FRONT CHANNEL ASSY
C	1	709120	SIDE CHANNEL ASSY LH
D	1	709121	SIDE CHANNEL ASSY RH
E	40	409000	AXLE CONNECTOR - FEMALE
F	40	409001	AXLE CONNECTOR - MALE
G	40	409002	CRANK ARM - LONG
H	40	409004	END CRANK - R.H.
I	40	409005	END CRANK - L.H.
J	7	212366	PUSHNUT - .250 STUD DIA.
K	1	222040	SNAP RING
L	1	709117	DIVIDER ASSEMBLY
M	1	709122	ADJUST. BAR ASSY
N	80	409175	SLAT
O	-	-	-
P	-	-	-
-	2	202310	BOLT - MACHINE HEX HD.
-	1	202570	HBOLT 0.3750-16x2.75x1-N
-	4	206070	CAP SCREW - FLAT HD. HX. SOC
-	3	212189	NUT - HEX. LOCK
-	4	212411	LOCKNUT M8-1.25
-	1	214280	WASHER - ST'D. FLAT

**PART NUMBER: 002623**

REVISION I.D. : **A**

DESCRIPTION: CNH CR970, CR980, 8010 CHAFFER

ITEM	QTY.	PART NUMBER	DESCRIPTION
A	1	709118	REAR TUBE ASSY
B	1	709119	FRONT CHANNEL ASSY
C	1	709120	SIDE CHANNEL ASSY LH
D	1	709121	SIDE CHANNEL ASSY RH
E	40	409000	AXLE CONNECTOR - FEMALE
F	40	409001	AXLE CONNECTOR - MALE
G	40	409002	CRANK ARM - LONG
H	40	409004	END CRANK - R.H.
I	40	409005	END CRANK - L.H.
J	7	212366	PUSHNUT - .250 STUD DIA.
K	1	222040	SNAP RING
L	1	709117	DIVIDER ASSEMBLY
M	1	709122	ADJUST. BAR ASSY
N	78	409176	SLAT - GATEWAY LT
O	2	409220	FLAT SLAT ST
P	-	-	-
-	2	202310	BOLT - MACHINE HEX HD.
-	1	202570	HBOLT 0.3750-16x2.75x1-N
-	4	206070	CAP SCREW - FLAT HD. HX. SOC
-	3	212189	NUT - HEX. LOCK
-	4	212411	LOCKNUT M8-1.25
-	1	214280	WASHER - ST'D. FLAT



# SERVICE PART LIST

**PART NUMBER: 002624**

**REVISION I.D. : A**

**DESCRIPTION: CNH CR970, CR980, 8010 CHAFFER**

ITEM	QTY.	PART NUMBER	DESCRIPTION
A	1	709118	REAR TUBE ASSY
B	1	709119	FRONT CHANNEL ASSY
C	1	709120	SIDE CHANNEL ASSY LH
D	1	709121	SIDE CHANNEL ASSY RH
E	40	409000	AXLE CONNECTOR - FEMALE
F	40	409001	AXLE CONNECTOR - MALE
G	40	409002	CRANK ARM - LONG
H	40	409004	END CRANK - R.H.
I	40	409005	END CRANK - L.H.
J	7	212366	PUSHNUT - .250 STUD DIA.
K	1	222040	SNAP RING
L	1	709117	DIVIDER ASSEMBLY
M	1	709122	ADJUST. BAR ASSY
N	78	409176	SLAT
O	2	409175	FLAT SLAT ST
P	-	-	-
Q	1	709259	DOES NOT APPLY
-	2	202310	BOLT - MACHINE HEX HD.
-	1	202570	HBOLT 0.3750-16x2.75x1-N
-	4	206070	CAP SCREW - FLAT HD. HX. SOC
-	3	212189	NUT - HEX LOCK
-	4	212411	LOCKNUT M8-1.25
-	1	214280	WASHER - STD. FLAT

**PART NUMBER: 002722**

**REVISION I.D. : A**

**DESCRIPTION: CNH E.A. WB 8010, CR, CX CHAFFER**

ITEM	QTY.	PART NUMBER	DESCRIPTION
A	1	709260	REAR TUBE ASSY
B	1	709119	FRONT CHANNEL ASSY
C	1	709125	SIDE CHANNEL ASSY LH
D	1	709126	SIDE CHANNEL ASSY RH
E	30	409000	AXLE CONNECTOR - FEMALE
F	30	409001	AXLE CONNECTOR - MALE
G	30	409002	CRANK ARM - LONG
H	30	409004	END CRANK - R.H.
I	30	409005	END CRANK - L.H.
J	7	212366	PUSHNUT - .250 STUD DIA.
K	1	222040	DOES NOT APPLY
L	1	709188	DIVIDER ASSEMBLY
M	1	409413	ADJUST. BAR
N	56	409176	SLAT - GATEWAY LT
O	2	409220	FLAT SLAT ST
P	2	409223	FLAT SLAT LT
Q	1	709259	HANDLE ASSEMBLY (E.A. ONLY)
R	-	-	-
-	2	202310	BOLT - MACHINE HEX HD.
-	1	202570	HBOLT 0.3750-16x2.75x1-N
-	4	206070	CAP SCREW - FLAT HD. HX. SOC
-	3	212189	NUT - HEX LOCK
-	4	212411	LOCKNUT M8-1.25
-	2	214280	WASHER - STD. FLAT

**PART NUMBER: 002721**

**REVISION I.D. : A**

**DESCRIPTION: CNH E.A. WB 8010, CR, CX SIEVE**

ITEM	QTY.	PART NUMBER	DESCRIPTION
A	1	709258	REAR TUBE ASSY
B	1	709119	FRONT CHANNEL ASSY
C	1	709120	SIDE CHANNEL ASSY LH
D	1	709121	SIDE CHANNEL ASSY RH
E	39	409000	AXLE CONNECTOR - FEMALE
F	39	409001	AXLE CONNECTOR - MALE
G	39	409002	CRANK ARM - LONG
H	41	409004	END CRANK - R.H.
I	41	409005	END CRANK - L.H.
J	8	212366	PUSHNUT - .250 STUD DIA.
K	1	222040	DOES NOT APPLY
L	1	709185	DIVIDER ASSEMBLY
M	1	409407	ADJUST. BAR
N	78	409175	SLAT
O	2	409220	FLAT SLAT ST
P	-	-	-
Q	1	709259	HANDLE ASSEMBLY (E.A. ONLY)
R	4	409408	ADJUST STRAP
S	1	409422	RETAINER
T	1	409423	RETAINER
-	2	202310	BOLT - MACHINE HEX HD.
-	1	202570	HBOLT 0.3750-16x2.75x1-N
-	4	206070	CAP SCREW - FLAT HD. HX. SOC.
-	3	212189	NUT - HEX LOCK
-	4	212411	LOCKNUT M8-1.25
-	2	214280	WASHER - STD. FLAT

**PART NUMBER: 002723**

**REVISION I.D. : A**

**DESCRIPTION: CNH E.A. WB 8010, CR, CX CHAFFER**

ITEM	QTY.	PART NUMBER	DESCRIPTION
A	1	709258	REAR TUBE ASSY
B	1	709119	FRONT CHANNEL ASSY
C	1	709120	SIDE CHANNEL ASSY LH
D	1	709121	SIDE CHANNEL ASSY RH
E	39	409000	AXLE CONNECTOR - FEMALE
F	39	409001	AXLE CONNECTOR - MALE
G	39	409002	CRANK ARM - LONG
H	41	409004	END CRANK - R.H.
I	41	409005	END CRANK - L.H.
J	8	212366	PUSHNUT - .250 STUD DIA.
K	1	222040	DOES NOT APPLY
L	1	709185	DIVIDER ASSEMBLY
M	1	409407	ADJUST. BAR ASSY
N	78	409175	SLAT
O	2	409220	FLAT SLAT ST
P	-	-	-
Q	1	709259	HANDLE ASSEMBLY (E.A. ONLY)
R	4	409408	ADJUST STRAP
-	2	202310	BOLT - MACHINE HEX HD.
-	1	202570	HBOLT 0.3750-16x2.75x1-N
-	4	206070	CAP SCREW - FLAT HD. HX. SOC.
-	3	212189	NUT - HEX LOCK
-	4	212411	LOCKNUT M8-1.25
-	2	214280	WASHER - STD. FLAT



GATEWAY<sup>®</sup> SIEVES

# SERVICE PART LIST

PART NUMBER: **002724**

REVISION I.D. : **A**

DESCRIPTION: CNH E.A. WB 8010, CR, CX SIEVE

<u>ITEM</u>	<u>QTY.</u>	<u>PART NUMBER</u>	<u>DESCRIPTION</u>
A	1	709258	REAR TUBE ASSY
B	1	709119	FRONT CHANNEL ASSY
C	1	709120	SIDE CHANNEL ASSY LH
D	1	709121	SIDE CHANNEL ASSY RH
E	39	409000	AXLE CONNECTOR - FEMALE
F	39	409001	AXLE CONNECTOR - MALE
G	39	409002	CRANK ARM - LONG
H	41	409004	END CRANK - R.H.
I	41	409005	END CRANK - L.H.
J	8	212366	PUSHNUT - .250 STUD DIA.
K	1	222040	DOES NOT APPLY
L	1	709185	DIVIDER ASSEMBLY
M	1	409407	ADJUST. BAR
N	78	409176	SLAT - GATEWAY LT
O	2	409220	FLAT SLAT ST
P	-	-	-
Q	1	709259	HANDLE ASSEMBLY (E.A. ONLY)
R	4	409408	ADJUST STRAP
S	1	409422	RETAINER
T	1	409423	RETAINER
-	2	202310	BOLT - MACHINE HEX HD.
-	1	202570	HBOLT 0.3750-16x2.75x1-N
-	4	206070	CAP SCREW - FLAT HD. HX. SOC.
-	3	212189	NUT - HEX. LOCK
-	4	212411	LOCKNUT M8-1.25
-	1	214280	WASHER - STD. FLAT



**IF YOU HAVE OTHER QUESTIONS:** Please contact your dealer or distributor.

You may also email or visit our website at:

**e-mail:** [info@hccinc.com](mailto:info@hccinc.com)

**web:** [www.hccinc.com](http://www.hccinc.com)

This manual is also available for download at: <http://www.hccinc.com/gateway-combine-sieves-and-combine-chaffers>

**HCC, inc.**  
1501 1<sup>ST</sup> Avenue – Mendota, Illinois 61342  
(815) 539-9371 Fax (815) 539-3135  
**WARRANTY REGISTRATION**

Delivery Date \_\_\_\_\_ Ultimate User \_\_\_\_\_

Address \_\_\_\_\_

City, State (Province) \_\_\_\_\_ Zip/Postal Code \_\_\_\_\_

Country \_\_\_\_\_ Telephone (\_\_\_\_) \_\_\_\_\_

---

---

Dealer/Distributor Name \_\_\_\_\_

Dealer/Distributor Customer Number \_\_\_\_\_ Telephone (\_\_\_\_) \_\_\_\_\_

Address \_\_\_\_\_

City, State (Province) \_\_\_\_\_ Zip/Postal Code \_\_\_\_\_

Country \_\_\_\_\_

---

---

**To be completed by DEALER / DISTRIBUTOR or ULTIMATE USER:**

**Please place an (X) in front of the product or products you are submitting this Warranty Registration form for.**

- \_\_\_\_\_ Orbit Reel \_\_\_\_\_ Product kit number
- \_\_\_\_\_ Gateway Sieve or chaffer \_\_\_\_\_ Product frame number
- \_\_\_\_\_ Reel
- \_\_\_\_\_ Other / List \_\_\_\_\_

**Please make a copy of this WARRANTY REGISTRATION form for your records and return the original to:**

**Marketing & Sales Manager  
HCC, Inc.  
1501 1<sup>ST</sup> Avenue  
Mendota, Illinois 61342 USA**

**Form must be completed and returned to HCC, Inc. within 30 days from receipt of delivery or warranty may become void.**

**HCC, inc.**  
1501 1<sup>st</sup> Avenue – Mendota, Illinois 61342  
(815) 539-9371 Fax (815) 539-3135  
**LIMITED WARRANTY**

HCC, inc. warrants each new HCC, inc. product to be free from defects in material and workmanship. This warranty is applicable only for the normal service life expectancy of the product or components, not to exceed 12 consecutive months from the date of delivery of the new HCC, inc. product to the original purchaser.

Genuine HCC, inc. replacement parts and components will be warranted for 90 days from date of purchase, or the remainder of the original equipment warranty period, whichever is longer. There is no warranty for tires.

Under no circumstances will it cover any merchandise or components thereof, which, in the opinion of the company, has been subjected to misuse, unauthorized modifications, alteration, an accident, or if repairs have been made with parts other than those obtainable through HCC, inc.

Our obligation under this warranty shall be limited to repairing or replacing, free of charge to the original purchaser, any part that, in our judgment, shall show evidence of such defect, provided further that such part shall be returned within thirty (30) days from date of failure to HCC, inc., routed through the dealer and distributor from whom the purchase was made, transportation charges prepaid.

This warranty shall not be interpreted to render HCC, inc. liable for injury or damages of any kind or nature to person or property. This warranty does not extend to the loss of crops, loss because of delay in harvesting, or any expense or loss incurred for labor, substitute machinery, rental, or for any other reason.

Except as set forth above, **HCC, inc. shall have no obligation or liability of any kind on account of any of its equipment and shall not be liable for special or consequential damages. HCC, inc. makes no other warranty, expressed or implied, and specifically, HCC, inc. disclaims any implied warranty of merchantability or fitness for a particular purpose. Some states or provinces do not permit limitations or exclusions of implied warranties or incidental or consequential damages, so the limitations or exclusion in this warranty may not apply.**

This warranty is subject to any existing conditions of supply which may directly affect our ability to obtain materials or manufacture replacement parts.

HCC, inc. reserves the right to make improvements in design or changes in specifications at any time, without incurring any obligation to owners of units previously sold.

No one is authorized to alter, modify, or enlarge this warranty nor the exclusion, limitations, and reservations.

**Effective with products delivered to original user on or after January 1, 2006**