



# Gateway

SIEVE & CHAFFER SYSTEM

## *Parts Book*

Four Panel, Single Adjustment Frames

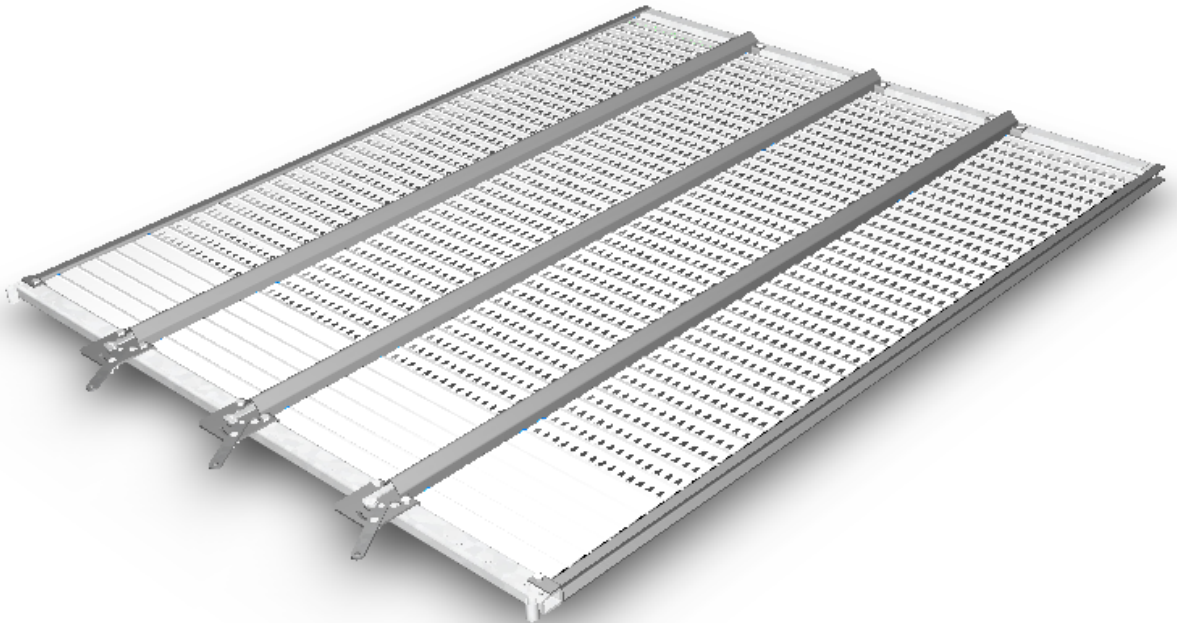

U.S. PATENT No. 6890253  
AND FOREIGN PATENTS PENDING

# **GATEWAY DIAGRAM**

The Gateway diagram on this page is generic, covering a wide variety of OEM equipment. A detailed parts list is available on the following page(s) for each specific sieve.

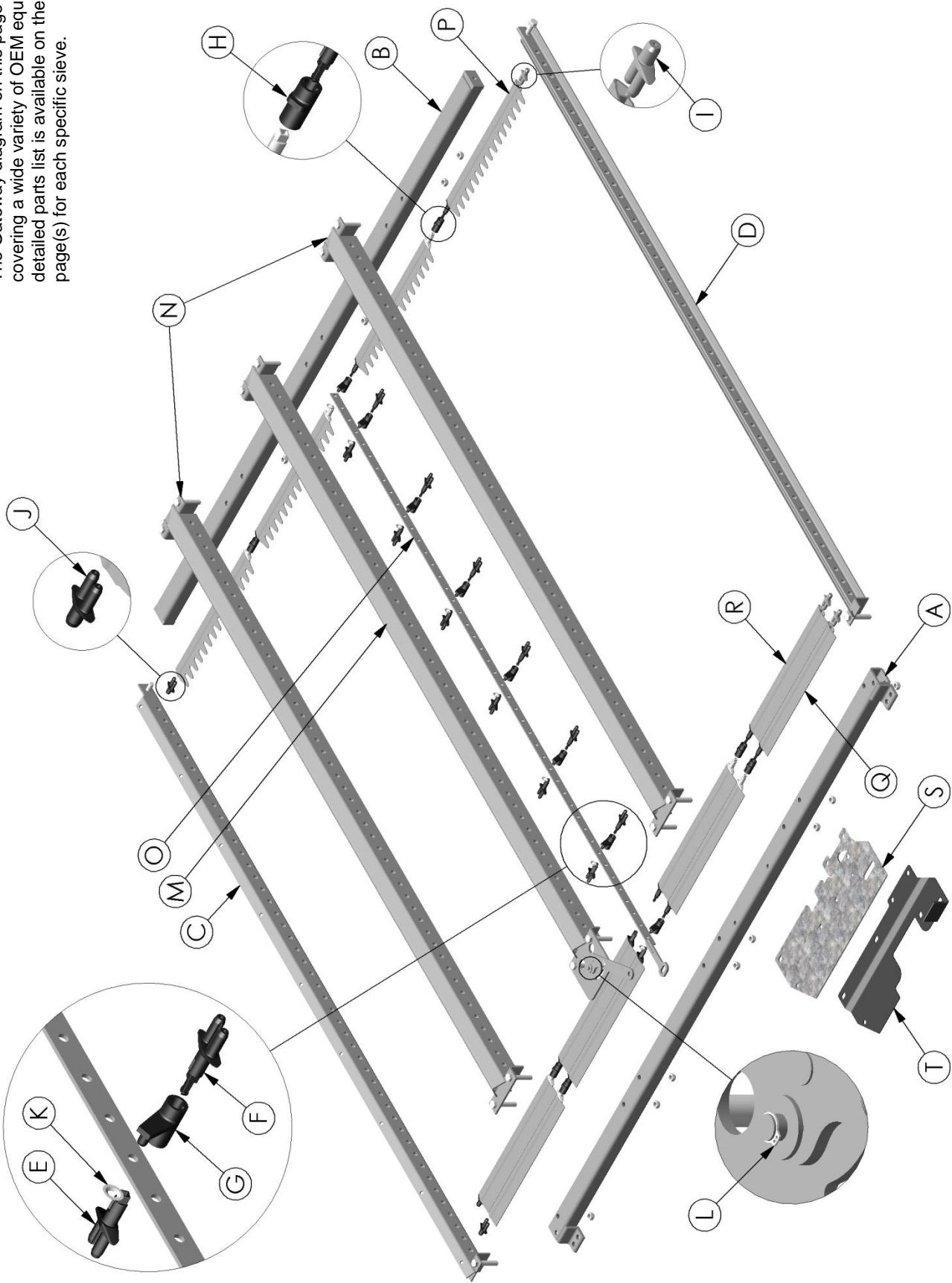



# SERVICE PART LIST

**PART NUMBER: 002601**

REVISION I.D. : **C**

DESCRIPTION: CASE 1680, 1688, 2188, 2388 SIEVE  
S/N JJC 0047412 AND UP

ITEM	QTY.	PART NUMBER	DESCRIPTION
A	1	709000	REAR TUBE ASSY
B	1	709001	FRONT TUBE ASSY
C	1	709002	SIDE CHANNEL ASSY - LH
D	1	709003	SIDE CHANNEL ASSY - RH
E	138	409000	AXLE CONNECTOR
F	138	409001	AXLE CONNECTOR
G	46	409002	CRANK ARM - LONG
H	92	409003	CRANK ARM - SHORT
I	46	409004	END CRANK - R.H.
J	46	409005	END CRANK - L.H.
K	8	212366	PUSHNUT - .250 STUD DIA.
L	1	222042	SNAP RING
M	1	709251	HANDLE ASSY
N	3	709005	DIVIDER ASSEMBLY
O	1	709006	ADJUSTMENT BAR ASSY.
P	184	409006	SIEVE SLAT
Q	-	-	-
R	-	-	-
-	2	202191	BOLT - HEX
-	14	202510	BOLT - MACHINE HEX HD.
-	14	212189	NUT - HEX LOCK
-	2	214130	WASHER-STD. FLAT

**PART NUMBER: 002604**

REVISION I.D. : **C**

DESCRIPTION: CASE 1680, 1688, 2188, 2388 SIEVE  
S/N JJC 0047412 AND UP

ITEM	QTY.	PART NUMBER	DESCRIPTION
A	1	709000	REAR TUBE ASSY
B	1	709001	FRONT TUBE ASSY
C	1	709002	SIDE CHANNEL ASSY - LH
D	1	709003	SIDE CHANNEL ASSY - RH
E	138	409000	AXLE CONNECTOR
F	138	409001	AXLE CONNECTOR
G	46	409002	CRANK ARM - LONG
H	92	409003	CRANK ARM - SHORT
I	46	409004	END CRANK - R.H.
J	46	409005	END CRANK - L.H.
K	8	212366	PUSHNUT - .250 STUD DIA.
L	1	222042	SNAP RING
M	1	709251	HANDLE ASSY.
N	3	709005	DIVIDER ASSEMBLY
O	1	709006	ADJUSTMENT BAR ASSY.
P	180	409057	SLAT - GATEWAY LT
Q	4	409006	SIEVE SLAT
R	-	-	-
-	2	202191	BOLT - HEX
-	14	202510	BOLT - MACHINE HEX HD.
-	14	212189	NUT - HEX LOCK
-	2	214130	WASHER - HEL. SPRING LOCK

**PART NUMBER: 002606**

REVISION I.D. : **C**

DESCRIPTION: CASE 1480, 1482, 1680, 1682 SIEVE  
PRIOR TO S/N JJC 0047412

ITEM	QTY.	PART NUMBER	DESCRIPTION
A	1	409036	REAR TUBE
B	1	709001	FRONT TUBE ASSY
C	1	709151	SIDE CHANNEL ASSY - LH
D	1	709152	SIDE CHANNEL ASSY - RH
E	108	409000	AXLE CONNECTOR- FEMALE
F	108	409001	AXLE CONNECTOR- MALE
G	36	409002	CRANK ARM - LONG
H	72	409003	CRANK ARM - SHORT
I	36	409004	END CRANK - R.H.
J	36	409005	END CRANK - L.H.
K	6	212366	PUSHNUT - .250 STUD DIA.
L	1	222042	SNAP RING
M	1	709251	HANDLE ASSY.
N	3	709154	DIVIDER ASSEMBLY
O	1	709155	ADJUSTMENT BAR ASSY.
P	144	409006	SIEVE SLAT
Q	-	-	-
R	-	-	-
-	2	202191	BOLT - HEX
-	14	202510	BOLT - MACHINE HEX HD.
-	14	212189	NUT - HEX LOCK
-	2	214130	WASHER - HEL. SPRING LOCK

**PART NUMBER: 002609**

REVISION I.D. : **D**

DESCRIPTION: CASE 1480, 1482, 1680, 1682 SIEVE  
PRIOR TO S/N JJC 0047412

ITEM	QTY.	PART NUMBER	DESCRIPTION
A	1	409036	REAR TUBE
B	1	709001	FRONT TUBE ASSY
C	1	709151	SIDE CHANNEL ASSY - LH
D	1	709152	SIDE CHANNEL ASSY - RH
E	108	409000	AXLE CONNECTOR- FEMALE
F	108	409001	AXLE CONNECTOR- MALE
G	36	409002	CRANK ARM - LONG
H	72	409003	CRANK ARM - SHORT
I	36	409004	END CRANK - R.H.
J	36	409005	END CRANK - L.H.
K	6	212366	PUSHNUT - .250 STUD DIA.
L	1	222042	SNAP RING
M	1	709251	HANDLE ASSY.
N	3	709154	DIVIDER ASSEMBLY
O	1	709155	ADJUSTMENT BAR ASSY.
P	144	409057	SLAT - GATEWAY LT
Q	4	409006	SIEVE SLAT
R	-	-	-
-	2	202191	BOLT - HEX
-	14	202510	BOLT - MACHINE HEX HD.
-	14	212189	NUT - HEX LOCK
-	2	214130	WASHER - HEL. SPRING LOCK



GATEWAY® SIEVES

# SERVICE PART LIST

**PART NUMBER: 002701**

REVISION I.D. : New

DESCRIPTION: CASE 2388, AF 130, 50/60/7088

**PART NUMBER: 002604**

REVISION I.D. : New

DESCRIPTION: CASE 2388, AF 130, 50/60/7088

<u>ITEM</u>	<u>QTY.</u>	<u>PART NUMBER</u>	<u>DESCRIPTION</u>
A	1	709000	REAR TUBE ASSY
B	1	709001	FRONT TUBE ASSY
C	1	709002	SIDE CHANNEL ASSY - LH
D	1	709003	SIDE CHANNEL ASSY - RH
E	138	409000	AXLE CONNECTOR
F	138	409001	AXLE CONNECTOR
G	46	409002	CRANK ARM - LONG
H	92	409003	CRANK ARM - SHORT
I	46	409004	END CRANK - R.H.
J	46	409005	END CRANK - L.H.
K	8	212366	PUSHNUT - .250 STUD DIA.
L	1	222042	SNAP RING
M	1	709251	HANDLE ASSY
N	3	709005	DIVIDER ASSEMBLY
O	1	709006	ADJUSTMENT BAR ASSY.
P	184	409006	SIEVE SLAT
Q	-	-	-
R	-	-	-
S	1	409400	MOUNTING PLATE
T	1	409401	MOUNTING PLATE

<u>ITEM</u>	<u>QTY.</u>	<u>PART NUMBER</u>	<u>DESCRIPTION</u>
A	1	709000	REAR TUBE ASSY
B	1	709001	FRONT TUBE ASSY
C	1	709002	SIDE CHANNEL ASSY - LH
D	1	709003	SIDE CHANNEL ASSY - RH
E	138	409000	AXLE CONNECTOR
F	138	409001	AXLE CONNECTOR
G	46	409002	CRANK ARM - LONG
H	92	409003	CRANK ARM - SHORT
I	46	409004	END CRANK - R.H.
J	46	409005	END CRANK - L.H.
K	8	212366	PUSHNUT - .250 STUD DIA.
L	1	222042	SNAP RING
M	1	709251	HANDLE ASSY.
N	3	709005	DIVIDER ASSEMBLY
O	1	709006	ADJUSTMENT BAR ASSY.
P	180	409057	SLAT - GATEWAY LT
Q	4	409006	SIEVE SLAT
R	-	-	-
S	1	409400	MOUNTING PLATE
T	1	409401	MOUNTING PLATE

**HCC, inc.**  
1501 1<sup>ST</sup> Avenue – Mendota, Illinois 61342  
(815) 539-9371 Fax (815) 539-3135  
**WARRANTY REGISTRATION**

Delivery Date \_\_\_\_\_ Ultimate User \_\_\_\_\_

Address \_\_\_\_\_

City, State (Province) \_\_\_\_\_ Zip/Postal Code \_\_\_\_\_

Country \_\_\_\_\_ Telephone (\_\_\_\_) \_\_\_\_\_

---

---

Dealer/Distributor Name \_\_\_\_\_

Dealer/Distributor Customer Number \_\_\_\_\_ Telephone (\_\_\_\_) \_\_\_\_\_

Address \_\_\_\_\_

City, State (Province) \_\_\_\_\_ Zip/Postal Code \_\_\_\_\_

Country \_\_\_\_\_

---

---

**To be completed by DEALER / DISTRIBUTOR or ULTIMATE USER:**

**Please place an (X) in front of the product or products you are submitting this Warranty Registration form for.**

- \_\_\_\_\_ Orbit Reel \_\_\_\_\_ Product kit number
- \_\_\_\_\_ Gateway Sieve or chaffer \_\_\_\_\_ Product frame number
- \_\_\_\_\_ Reel
- \_\_\_\_\_ Other / List \_\_\_\_\_

**Please make a copy of this WARRANTY REGISTRATION form for your records and return the original to:**

**Marketing & Sales Manager  
HCC, Inc.  
1501 1<sup>ST</sup> Avenue  
Mendota, Illinois 61342 USA**

**Form must be completed and returned to HCC, Inc. within 30 days from receipt of delivery or warranty may become void.**

**HCC, inc.**  
1501 1<sup>st</sup> Avenue – Mendota, Illinois 61342  
(815) 539-9371 Fax (815) 539-3135  
**LIMITED WARRANTY**

HCC, inc. warrants each new HCC, inc. product to be free from defects in material and workmanship. This warranty is applicable only for the normal service life expectancy of the product or components, not to exceed 12 consecutive months from the date of delivery of the new HCC, inc. product to the original purchaser.

Genuine HCC, inc. replacement parts and components will be warranted for 90 days from date of purchase, or the remainder of the original equipment warranty period, whichever is longer. There is no warranty for tines.

Under no circumstances will it cover any merchandise or components thereof, which, in the opinion of the company, has been subjected to misuse, unauthorized modifications, alteration, an accident, or if repairs have been made with parts other than those obtainable through HCC, inc.

Our obligation under this warranty shall be limited to repairing or replacing, free of charge to the original purchaser, any part that, in our judgment, shall show evidence of such defect, provided further that such part shall be returned within thirty (30) days from date of failure to HCC, inc., routed through the dealer and distributor from whom the purchase was made, transportation charges prepaid.

This warranty shall not be interpreted to render HCC, inc. liable for injury or damages of any kind or nature to person or property. This warranty does not extend to the loss of crops, loss because of delay in harvesting, or any expense or loss incurred for labor, substitute machinery, rental, or for any other reason.

Except as set forth above, **HCC, inc. shall have no obligation or liability of any kind on account of any of its equipment and shall not be liable for special or consequential damages. HCC, inc. makes no other warranty, expressed or implied, and specifically, HCC, inc. disclaims any implied warranty of merchantability or fitness for a particular purpose. Some states or provinces do not permit limitations or exclusions of implied warranties or incidental or consequential damages, so the limitations or exclusion in this warranty may not apply.**

This warranty is subject to any existing conditions of supply which may directly affect our ability to obtain materials or manufacture replacement parts.

HCC, inc. reserves the right to make improvements in design or changes in specifications at any time, without incurring any obligation to owners of units previously sold.

No one is authorized to alter, modify, or enlarge this warranty nor the exclusion, limitations, and reservations.

**Effective with products delivered to original user on or after January 1, 2006**