



Gateway

SIEVE & CHAFFER SYSTEM

Parts Book

Three Panel, Single Adjustment Frames

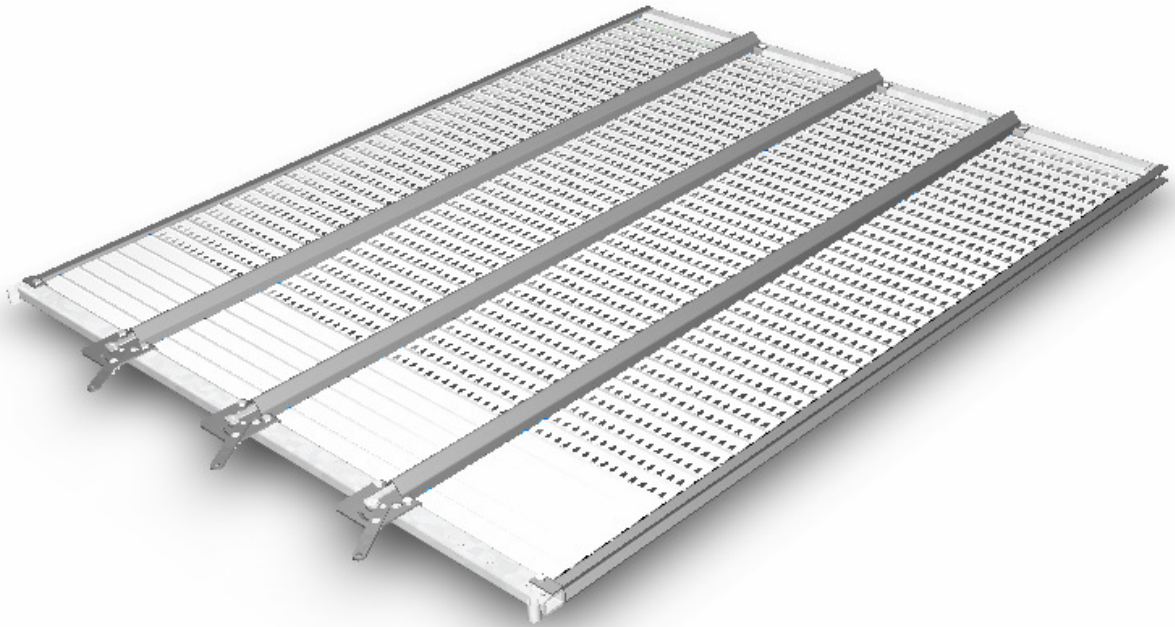

HCC, Inc.
1501 1st Avenue
Mendota, IL 61342
815-539-9371
www.hccincorporated.com

C-1136

GATEWAY DIAGRAM

The Gateway diagram on this page is generic, covering a wide variety of OEM equipment. A detailed parts list is available on the following page(s) for each specific sieve.

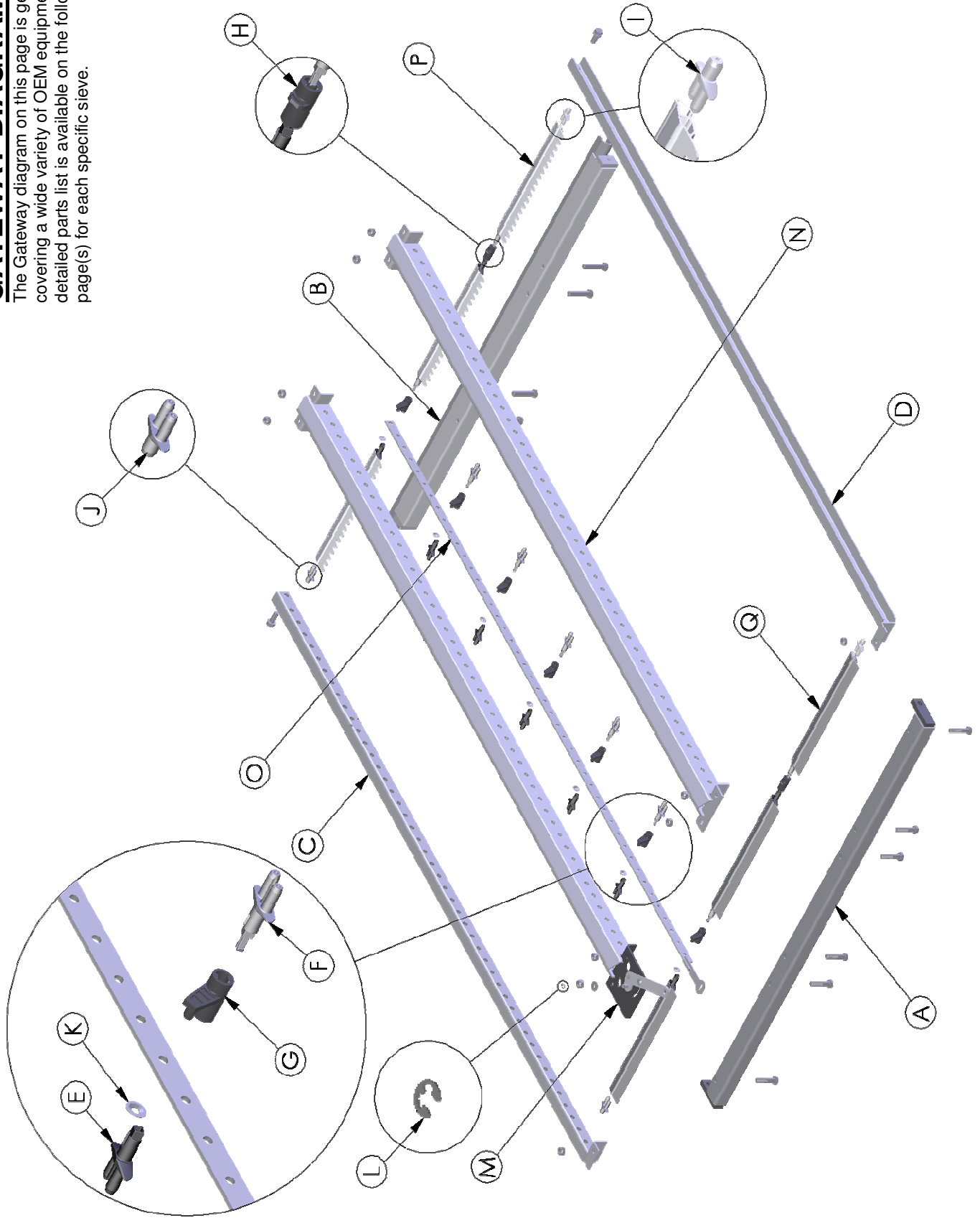



SERVICE PART LIST

PART NUMBER: 002611

REVISION I.D. : **A**

DESCRIPTION: CASE 1644, 1666, 2144, 2166, 2344, 2366,
1660 SIEVE S/N JJC 0039550 AND UP

ITEM	QTY.	PART NUMBER	DESCRIPTION
A	1	709103	REAR CHANNEL ASSY
B	1	709102	FRONT CHANNEL ASSY
C	1	709104	SIDE CHANNEL ASSY - LH
D	1	709105	SIDE CHANNEL ASSY - RH
E	92	409000	AXLE CONNECTOR- FEMALE
F	92	409001	AXLE CONNECTOR- MALE
G	46	409002	CRANK ARM - LONG
H	46	409003	CRANK ARM - SHORT
I	46	409004	END CRANK - R.H.
J	46	409005	END CRANK - L.H.
K	7	212366	PUSHNUT - .250 STUD DIA.
L	1	222042	SNAP RING
M	1	709251	HANDLE ASSY.
N	2	709107	DIVIDER ASSEMBLY
O	1	709006	ADJUSTMENT BAR ASSY.
P	138	409006	SIEVE SLAT
Q	-	-	-
-	3	409457	FILLER PIECE
-	2	202190	BOLT - HEX
-	2	214130	WASHER - HEL. SPRING LOCK
-	10	212189	NUT - HEX LOCK
-	2	202191	BOLT - HEX
-	8	202130	BOLT - MACHINE HEX. HD.

PART NUMBER: 002616

REVISION I.D. : **A**

DESCRIPTION: CASE 1440, 1460, 1640, 1660 SIEVE
PRIOR TO S/N JJC 0039550

ITEM	QTY.	PART NUMBER	DESCRIPTION
A	1	709103	REAR CHANNEL ASSY
B	1	709102	FRONT CHANNEL ASSY
C	1	709146	SIDE CHANNEL ASSY - LH
D	1	709147	SIDE CHANNEL ASSY - RH
E	72	409000	AXLE CONNECTOR-FEMALE
F	72	409001	AXLE CONNECTOR-MALE
G	36	409002	CRANK ARM - LONG
H	36	409003	CRANK ARM - SHORT
I	36	409004	END CRANK - R.H.
J	36	409005	END CRANK - L.H.
K	6	212366	PUSHNUT - .250 STUD DIA.
L	1	222042	SNAP RING
M	1	709251	DIVIDER ASSEMBLY
N	2	709149	DIVIDER ASSEMBLY
O	1	709155	ADJUSTMENT BAR ASSY.
P	108	409006	SIEVE SLAT
Q	-	-	-
-	8	202130	BOLT - MACHINE HEX. HD.
-	2	202191	BOLT - HEX
-	10	212189	NUT - HEX LOCK
-	2	214130	WASHER - HEL. SPRING LOCK
-	2	202190	BOLT - HEX
-	3	409289	FILLER PIECE

PART NUMBER: 002614

REVISION I.D. : **A**

DESCRIPTION: CASE 1644, 1666, 2144, 2166, 2344,
2366, 1660 SIEVE S/N JJC 0039550 AND UP

ITEM	QTY.	PART NUMBER	DESCRIPTION
A	1	709103	REAR CHANNEL ASSY
B	1	709102	FRONT CHANNEL ASSY
C	1	709104	SIDE CHANNEL ASSY - LH
D	1	709105	SIDE CHANNEL ASSY - RH
E	92	409000	AXLE CONNECTOR- FEMALE
F	92	409001	AXLE CONNECTOR- MALE
G	46	409002	CRANK ARM - LONG
H	46	409003	CRANK ARM - SHORT
I	46	409004	END CRANK - R.H.
J	46	409005	END CRANK - L.H.
K	7	212366	PUSHNUT - .250 STUD DIA.
L	1	222042	SNAP RING
M	1	709251	DIVIDER ASSEMBLY
N	2	709107	DIVIDER ASSEMBLY
O	1	709006	ADJUSTMENT BAR ASSY.
P	135	409057	SLAT - GATEWAY LT
Q	3	409006	SIEVE SLAT
-	1	409457	FILLER PIECE
-	2	202190	BOLT - HEX
-	2	214130	WASHER - HEL. SPRING LOCK
-	10	212189	NUT - HEX LOCK
-	2	202191	BOLT - HEX
-	8	202130	BOLT - MACHINE HEX. HD.

PART NUMBER: 002619

REVISION I.D. : **A**

DESCRIPTION: CASE 1440, 1460, 1640, 1660 SIEVE
PRIOR TO S/N JJC 0039550

ITEM	QTY.	PART NUMBER	DESCRIPTION
A	1	709103	REAR CHANNEL ASSY
B	1	709102	FRONT CHANNEL ASSY
C	1	709146	SIDE CHANNEL ASSY - LH
D	1	709147	SIDE CHANNEL ASSY - RH
E	72	409000	AXLE CONNECTOR-FEMALE
F	72	409001	AXLE CONNECTOR-MALE
G	36	409002	CRANK ARM - LONG
H	36	409003	CRANK ARM - SHORT
I	36	409004	END CRANK - R.H.
J	36	409005	END CRANK - L.H.
K	6	212366	PUSHNUT - .250 STUD DIA.
L	1	222042	SNAP RING
M	1	709251	HANDLE ASSY.
N	2	709149	DIVIDER ASSEMBLY
O	1	709155	ADJUSTMENT BAR ASSY.
P	105	409057	SLAT - GATEWAY LT
Q	3	409006	SIEVE SLAT
-	8	202130	BOLT - MACHINE HEX. HD.
-	2	202191	BOLT - HEX
-	10	212189	NUT - HEX LOCK
-	2	214130	WASHER - HEL. SPRING LOCK
-	2	202190	BOLT - HEX
-	3	409289	FILLER PIECE